



**ANYBEND**

Q-CAP HANDLING INSTRUCTIONS

## WARNING: FRAGILE

Flexible fixtures contain sensitive electronics, requiring careful handling and installation to preserve their warranty. When unpacking flexible fixtures, handle them gently and test all fixtures upon receiving.

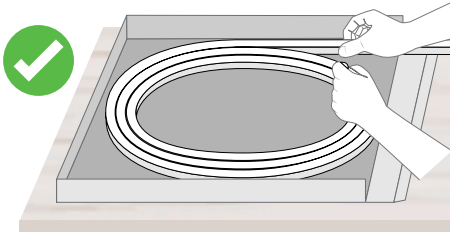

Keep the fixtures flat and supported when removing them from the box. Unroll them carefully on a flat surface and do not bend them against the intended bend direction.

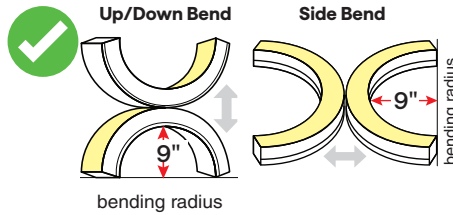

This ANYBEND fixture is omnidirectional and has up/down and side bending capabilities. Do not bend the fixture more than a 9" radius.

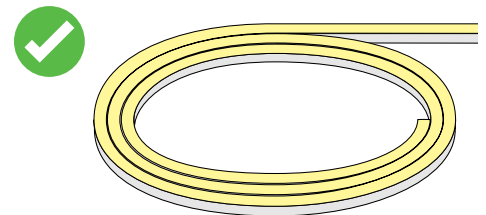

Powering the fixtures prior to installing will warm them up and make them more flexible, preventing damage.

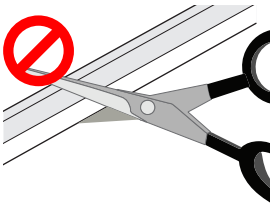

Q-CAP fixtures are not field cuttable. Field modifications void warranty.

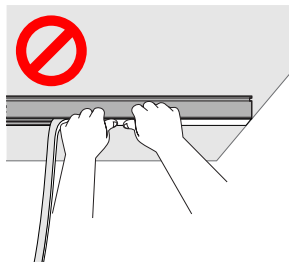

Do not let any portion of the fixture hang in any direction during installation. Use two people to install to ensure the fixture does not hang.

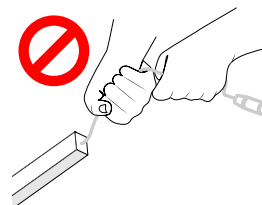
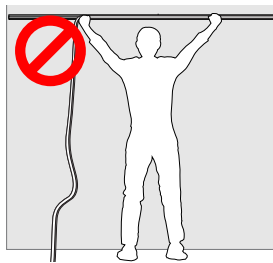

Do not grab or pull by the wire feeds.

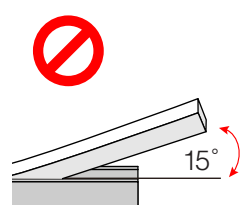

Do not bend the fixture more than 15 degrees when installing into mounting brackets or channels.

## MISHANDLING OF FIXTURES DURING INSTALLATION VOIDS WARRANTY

### TEMPERATURE RATINGS

Static White	1.0 W/FT		2.0 W/FT		4.0 W/FT	
	Min	Max	Min	Max	Min	Max
Ambient Operating Temp - Surface	-4°F	135°F	-4°F	130°F	-4°F	105°F
Storage Temp	-4°F	140°F	-4°F	140°F	-4°F	140°F
Installation Temp	50°F	100°F	50°F	100°F	50°F	100°F

Tunable & Warm Dim	DW 2.0 W/FT	
	Min	Max
Ambient Operating Temp - Surface	-4°F	135°F
Storage Temp	-4°F	140°F
Installation Temp	50°F	100°F

RGB	4.0 W/FT	
	Min	Max
Ambient Operating Temp - Surface	-4°F	110°F
Storage Temp	-4°F	140°F
Installation Temp	50°F	100°F